

Scan the QR code for assembly video.
Scanner ici pour visionner une vidéo de l'assemblage détaillé
Para ver un video de instrucciones detalladas sobre el montaje, escanee aquí.

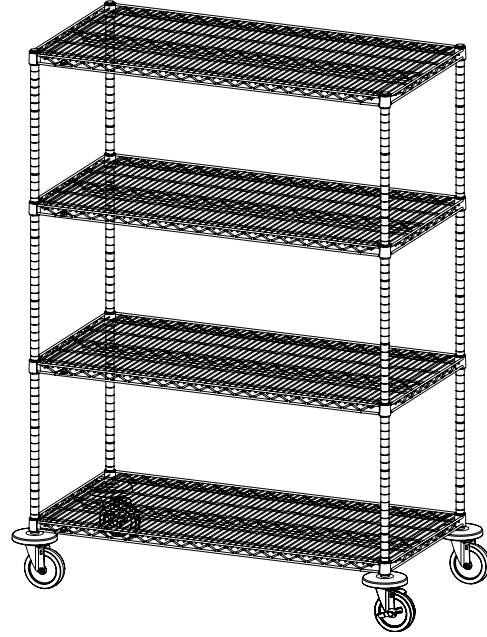

ASSEMBLY AND USE INSTRUCTIONS
WIRE SHELVING

Save this document for application, load rating, and safety reference.

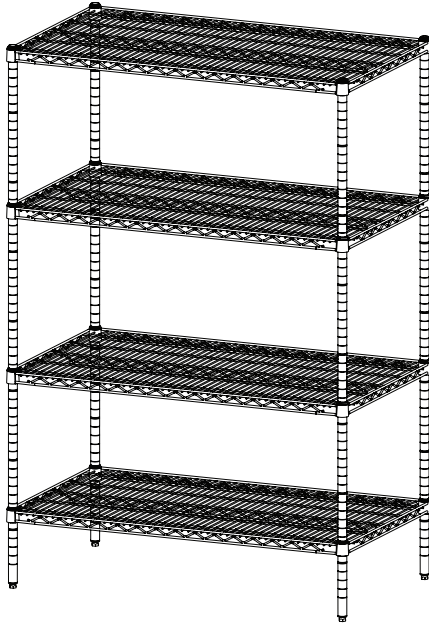

WARNING - STABILITY GUIDELINES / MAXIMUM ALLOWABLE POST HEIGHT

Shelf depth	Stationary Units (free-standing without footplates or wall brackets)	Mobile Units (with stem casters)
14 in. (356 mm)	63 in. (1600 mm)	54 in. (1372 mm)
18 in. (457 mm)	86 in. (2184 mm)	74 in. (1880 mm)
21 in. (533 mm)	86 in. (2184 mm)	74 in. (1880 mm)
24 in. (610 mm)	96 in. (2438 mm)	86 in. (2184 mm)

Note: For all stationary units with footplates or wall brackets properly attached to the floor or wall, the maximum allowable post height is 96 in. (2438 mm).

CAUTION - MAXIMUM LOAD CAPACITY

Load capacity per shelf (evenly distributed)		Load capacity per unit (evenly distributed)
800 lbs. (363 kg)	24 in. to 48 in. (610 mm to 1219 mm)	Stationary units have a maximum load capacity (evenly distributed) of 2,000 lbs. (907 kg). Mobile units have a maximum capacity of three times the caster load rating up to but not exceeding 1,000 lbs. (453 kg) total. Consult the Metro catalog for caster load ratings.
600 lbs. (272 kg)	54 in. (1370 mm) or longer	

WARNING - TIPPING HAZARD

- Do not stand or climb on shelving.
- Place heavy objects on lowest shelf.
- Distribute weight as evenly as possible.
- Do not drop heavy objects on shelves or subject units to shock such as forklifts or dollies.
- Move mobile units along long axis only.
- Shelves should be assembled with a maximum spacing of 30 in. (76cm).
- Place shelving on solid and level floors. Level the unit by adjusting the leveling feet.
- Install bottom shelf as low as possible. For mobile units with stem casters, bottom shelf **MUST** be assembled on the lowest possible groove.
- For 18 in. (457mm) deep Security units, use casters no longer than 5 in. in diameter.

Failure to follow these instructions could result in personal injury or property damage.



Olympic Gray-Guard™ and Green-Guard™ Epoxy Coated Product
Limited 10 Year Corrosion Warranty.

Scan the QR code for additional details.

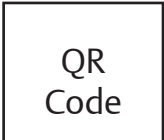

Stationary Unit Assembly

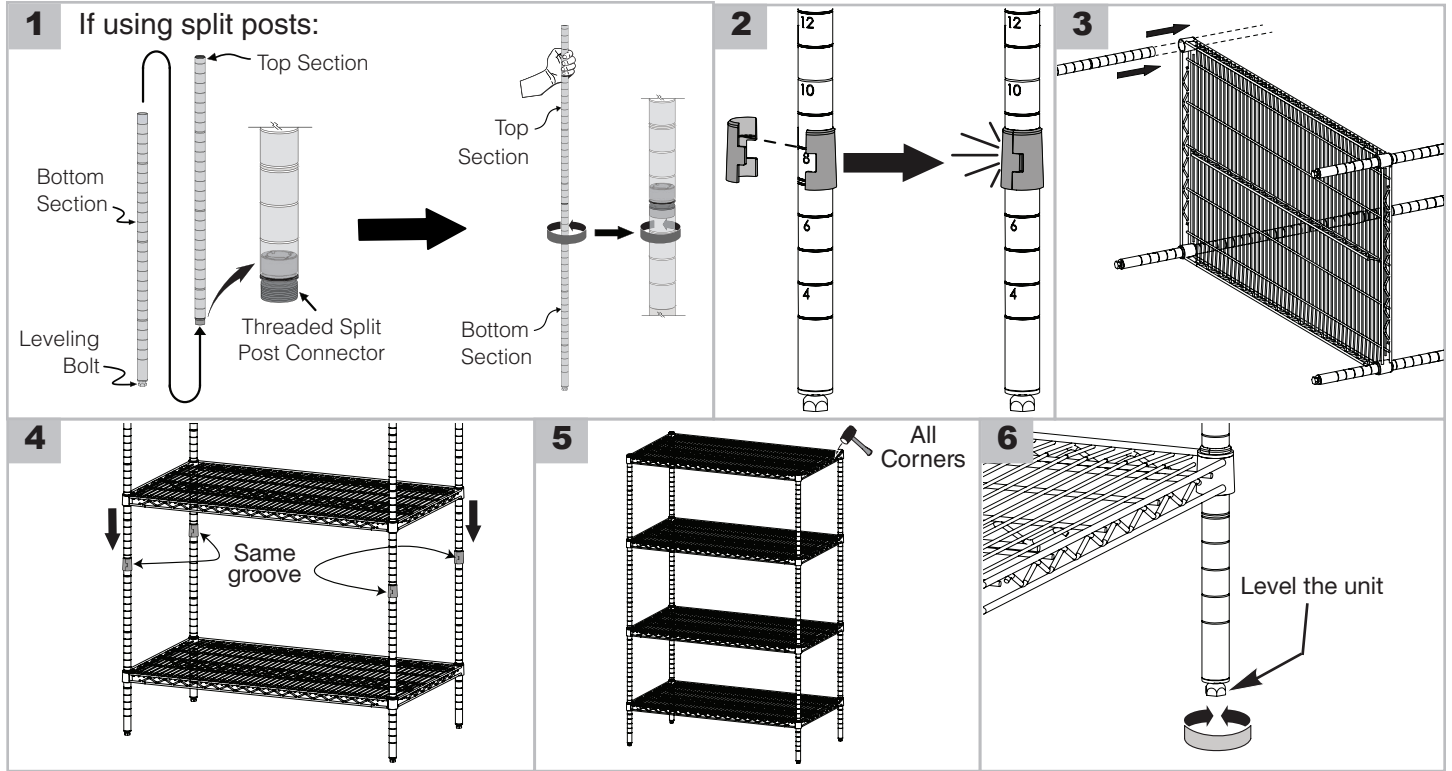

Mobile Unit Assembly

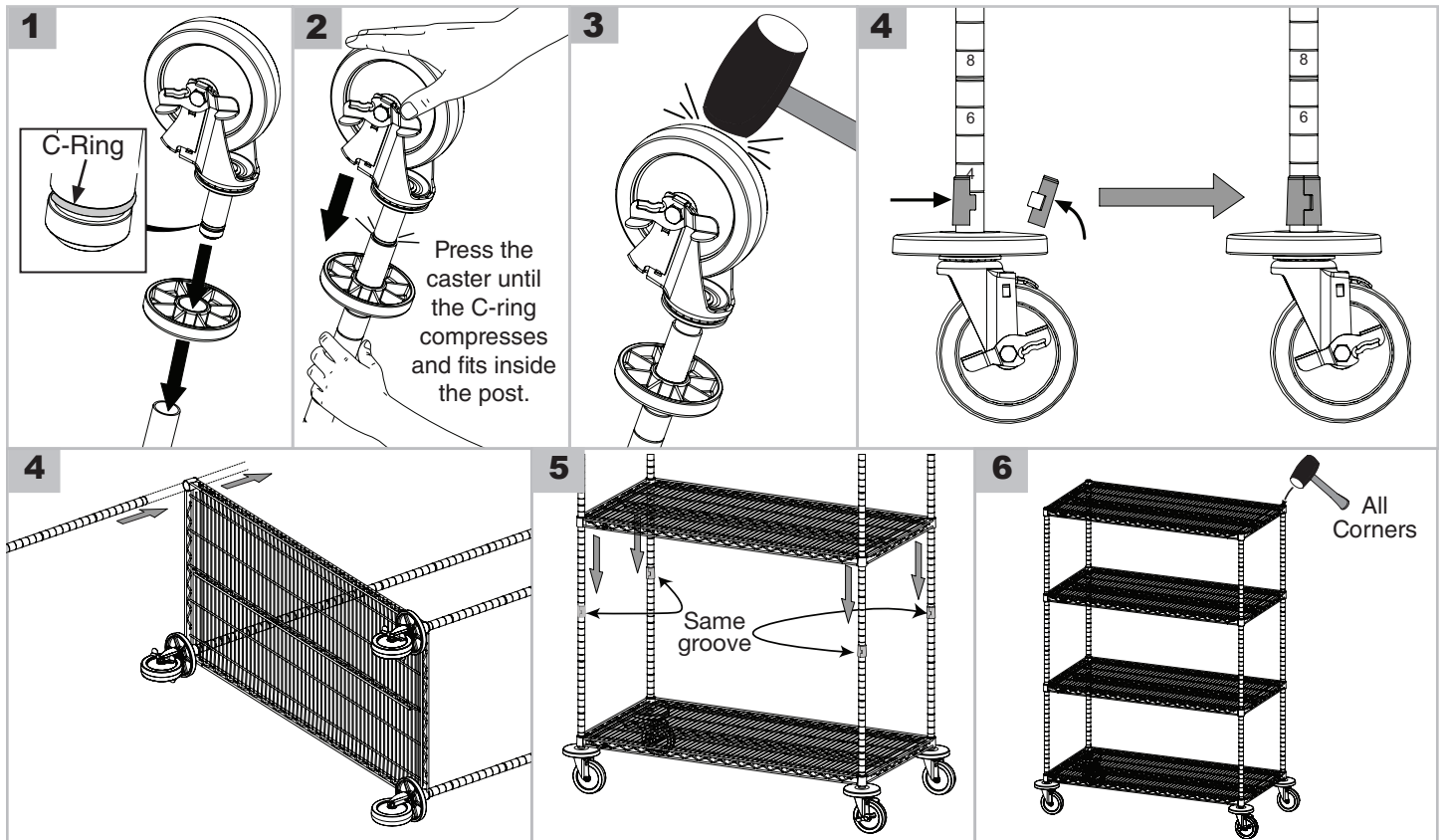

L01-340 REV E 08/25

Olympic Storage Company

For Product Information visit: olympicshelving.com

OLYMPIC
 STORAGE COMPANY